



**9-10 October 2021**

# Team Managers Manual

## Contents

Organising Committee .....	4
Address of the Organising Committee .....	4
Address of the Venue .....	4
Local Organising Committee .....	4
European Rowing .....	4
Safeguarding.....	4
General Information.....	5
Important Telephone Numbers .....	5
Venue Opening Hours .....	5
Team Information .....	5
Accreditation Centre .....	5
General Training Times .....	5
Practice Starts.....	6
Team Managers Meeting & Draw .....	6
Publications during the Event .....	6
Competition.....	7
Traffic Rules .....	7
Training.....	7
Practice Starts.....	7
Racing .....	8
Finals.....	8
Control Commission .....	9
Crew Changes & Registration.....	9
Bow Numbers .....	9
Athletes Weighing .....	9
Test Weighing.....	9
Boat Weighing .....	9
Weather updates/adverse weather scenarios.....	9
Weather Information per hour .....	9
Average Wind Speed .....	10
Average Temperature .....	10
Average Humidity.....	11
Average Temperature and Humidity .....	11
Sunrise, Sunset & Daylight Information .....	11

Team Facilities and Services .....	12
Venue Map .....	12
Boat Storage .....	13
Launch Pontoons .....	13
Team Tents .....	13
Changing Rooms, Showers and Toilets .....	13
Coaches Viewing .....	13
Baggage Drop .....	13
Lost and Found .....	13
Garbage Collection .....	13
Transportation and Parking Services for Teams .....	13
Food Facilities and Services .....	14
Lunch at the Venue .....	14
Mealtimes at the Hotels .....	14
Medical Facilities and Services .....	14
Medical Centre .....	14
Doping Control .....	14
First Aid Service, Ambulance and Local Hospital .....	14
Important Note .....	14
Covid-related rules and practices .....	14
Covid Pre-Health screening .....	14
Covid Test Centre Opening Hours .....	15
Spectators .....	15
Media .....	15
Media Accreditation .....	15
Media Centre .....	15
Partners .....	16
Sponsors .....	16

## Organising Committee

### Address of the Organising Committee

M-START UG (haftungsbeschränkt) für  
Regatta München e.V.  
Behringstraße 10  
82152 Planegg  
Phone +49-89-21231296-0  
E-mail: [info@regatta.de](mailto:info@regatta.de) | [www.erjch2021.com](http://www.erjch2021.com)

### Address of the Venue

Olympic Regatta Centre  
Dachauer Str. 35  
85764 Oberschleissheim

### Local Organising Committee

President	Oliver Bettzieche	<a href="mailto:o.bettzieche@regatta.de">o.bettzieche@regatta.de</a>
Vice-President	Philipp Dierken	<a href="mailto:p.dierken@regatta.de">p.dierken@regatta.de</a>
Competition	Philip Schmolling	<a href="mailto:p.schmolling@regatta.de">p.schmolling@regatta.de</a>
Sports Services	Elias Kraus	<a href="mailto:e.kraus@regatta.de">e.kraus@regatta.de</a>
Accreditation	Christian Vlach	<a href="mailto:c.vlach@regatta.de">c.vlach@regatta.de</a>
Accommodation	Edith Wittkopf	<a href="mailto:accommodation@regatta.de">accommodation@regatta.de</a>
Transport	David Hunstein	<a href="mailto:d.hunstein@regatta.de">d.hunstein@regatta.de</a>
Press & Media Officer	Cora Zillich	<a href="mailto:c.zillich@regatta.de">c.zillich@regatta.de</a>
Finance	Jörg Reinhardt	<a href="mailto:j.reinhardt@regatta.de">j.reinhardt@regatta.de</a>
Regatta Doctor	Dr. Norbert Kapeller	
	Dr. Dr. Michael Zyskowski	
Safeguarding Officer	Cora Zillich	<a href="mailto:c.zillich@regatta.de">c.zillich@regatta.de</a>
Safety & Infection Prevention	Stefan Kapeller	<a href="mailto:s.kapeller@regatta.de">s.kapeller@regatta.de</a>

## European Rowing

### European Rowing Board

Ryszard Stadniuk, Chair	Dušan Macháček
Annamarie Phelps, Deputy Chair and Event Safeguarding Officer	Algirdas Raslanas
Eva Szanto, Secretary	Patrick Rombaut
Nebojša Jevremović	

Technical Delegate	Pascal Jolly
President of the Jury	Stefanie Palfner
Event Manager	Matt Evans

### Safeguarding

All rowers, entourage, coaches, volunteers, and staff have a right to participate and work in a non-violent, safe and respectful environment. Behaviour and actions that constitute harassment and abuse shall not be tolerated. If you have concerns regarding harassment and abuse whilst you are at this European Rowing event, please contact the World Rowing Event Safeguarding Officer (Annamarie Phelps) at the European Rowing office or email [safeguarding@worldrowing.com](mailto:safeguarding@worldrowing.com) or the LOC Safeguarding Officer (Cora Zillich) at the event or email [c.zillich@regatta.de](mailto:c.zillich@regatta.de).

## General Information

### Important Telephone Numbers

Team Information (during opening times)	+49-(0)89-21231296-0
Medical assistance on site	+49-(0)89-31585-237

Fire & medical emergencies	112
Police	110

### Venue Opening Hours

Thursday, 7 October	08:00 – 18:00
Friday, 8 October	08:00 – 18:00
Saturday, 9 October	06:30 – 18:30
Sunday, 10 October	06:00 – 17:00

Trailer arrival only during the opening hours of the venue. Other arrival times only on prior request.

### Team Information

The Team Information (Venue Map No. 12) is located near the Boathouse area on the opposite side of the finish tower. The opening hours are:

Thursday, 7 October	09:00 – 17:30
Friday, 8 October	09:00 – 17:30
Saturday, 9 October	07:30 – 18:00
Sunday, 10 October	07:00 – 17:00

There will be no mailboxes for teams/team managers, all information will be published online and at the notice board at the team information.

### Accreditation Centre

Accreditation is mandatory for entering the venue. Accreditation passes will be issued to the team managers upon arrival at the venue. The Accreditation centre is located next to the entrance and the shuttle bus stop in boat hangar 1 (Venue Map No. 4). The opening hours are:

Thursday, 7 October	08:00 – 18:00
Friday, 8 October	08:00 – 18:00
Saturday, 9 October	06:30 – 18:30
Sunday, 10 October	06:00 – 12:00

The Accreditation Centre will also check for missing pre-event health questionnaires submitted online and inform the Team Managers accordingly.

### General Training Times

Thursday, 7 October	10:00 – 13:00 14:00 – 17:00
Friday, 8 October	10:00 – 13:00 14:00 – 16:30
Saturday, 9 October	07:30 – 09:00 16:20 – 18:00
Sunday, 10 October	07:30 – 08:30

### Practice Starts

Practice starts will take place on Friday, 8 October from 10:00 to 11:30 and will be carried out in lanes 4, 5, 6 and 7. Crews shall follow the published Traffic Rules for Practice Starts, in addition to any instructions of the marshals and the jury in the start area. If crews would like to repeat their practice starts, they must turn at the 400-meter mark, go into lanes 0 to 2 and row towards the start. Crews wishing to continue their training after the practice starts shall pass the 500-meter mark and follow the usual traffic rules for training.

### Team Managers Meeting & Draw

The Team Managers Meeting and the Draw will take place online on Friday, 8 October at 17:00. Team Managers will receive the link to join this meeting via the Team Manager WhatsApp Group.

### Publications during the Event

Start and results lists and other important information will be published on the World Rowing website event page (<https://worldrowing.com/event/2021-european-rowing-junior-championships>) and on-site at the team information centre.

## Competition

### Traffic Rules

### Training

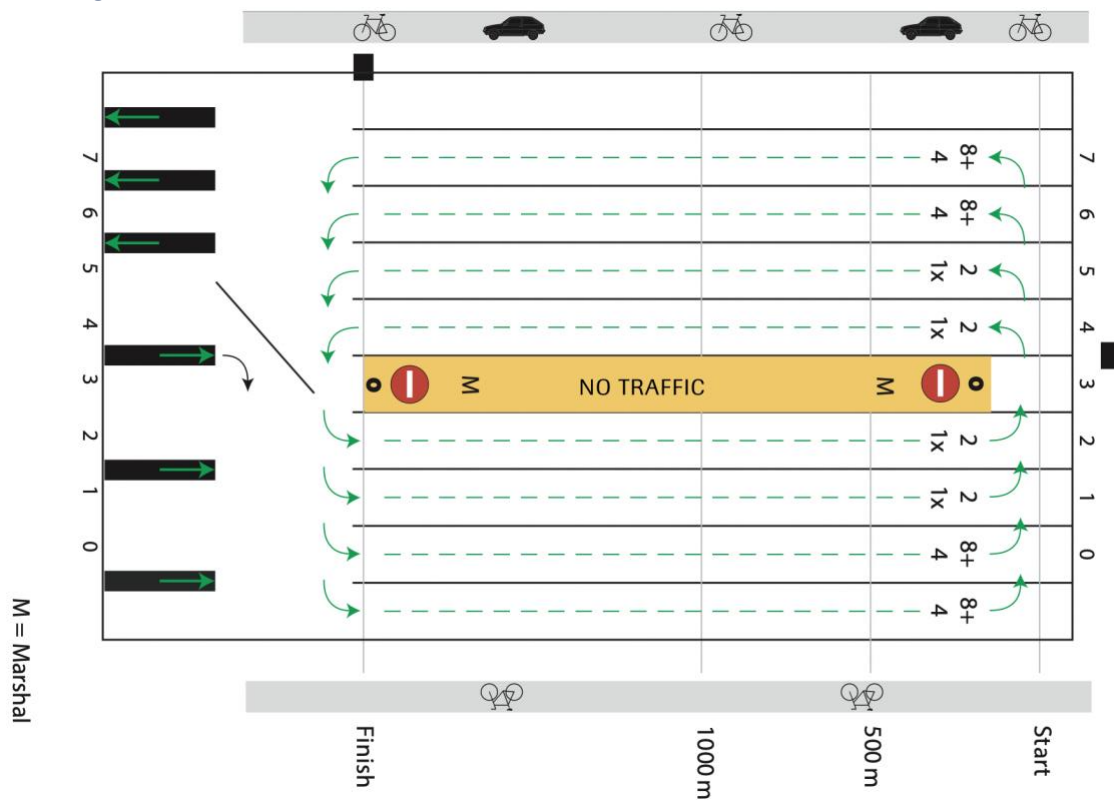

### Practice Starts

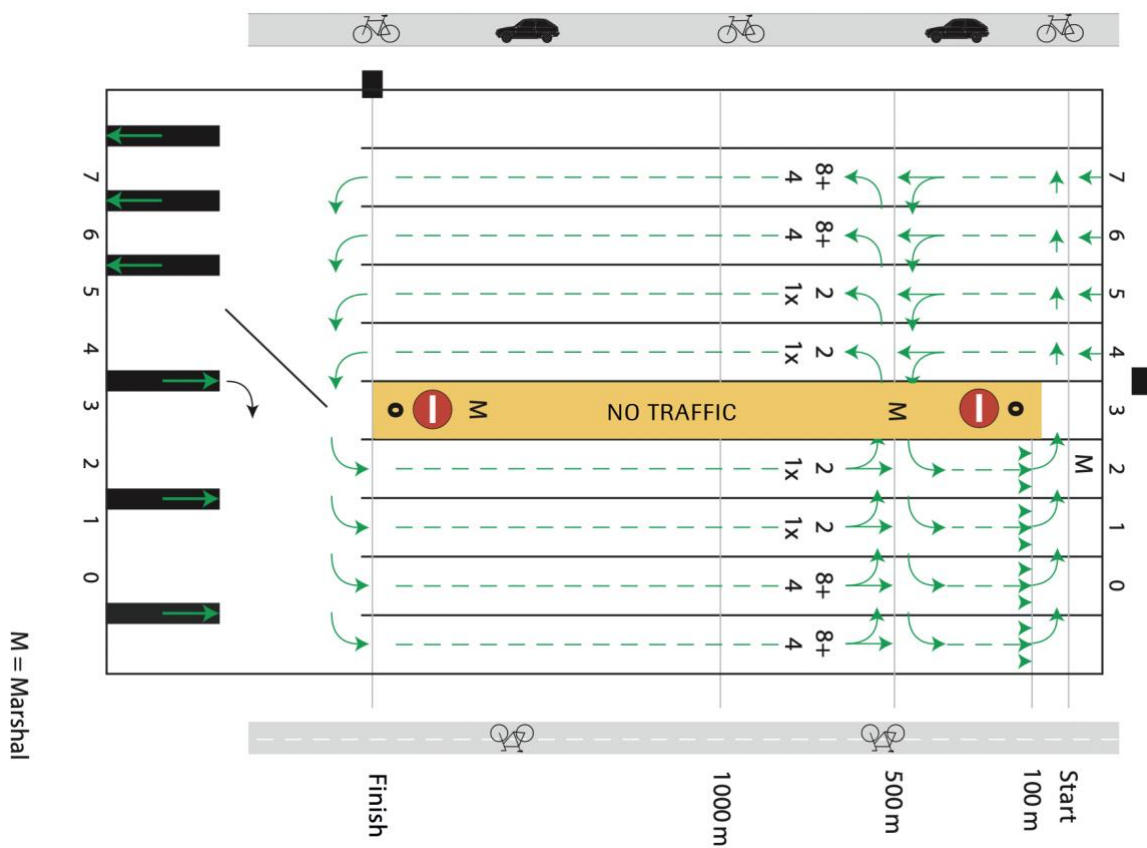

## Racing

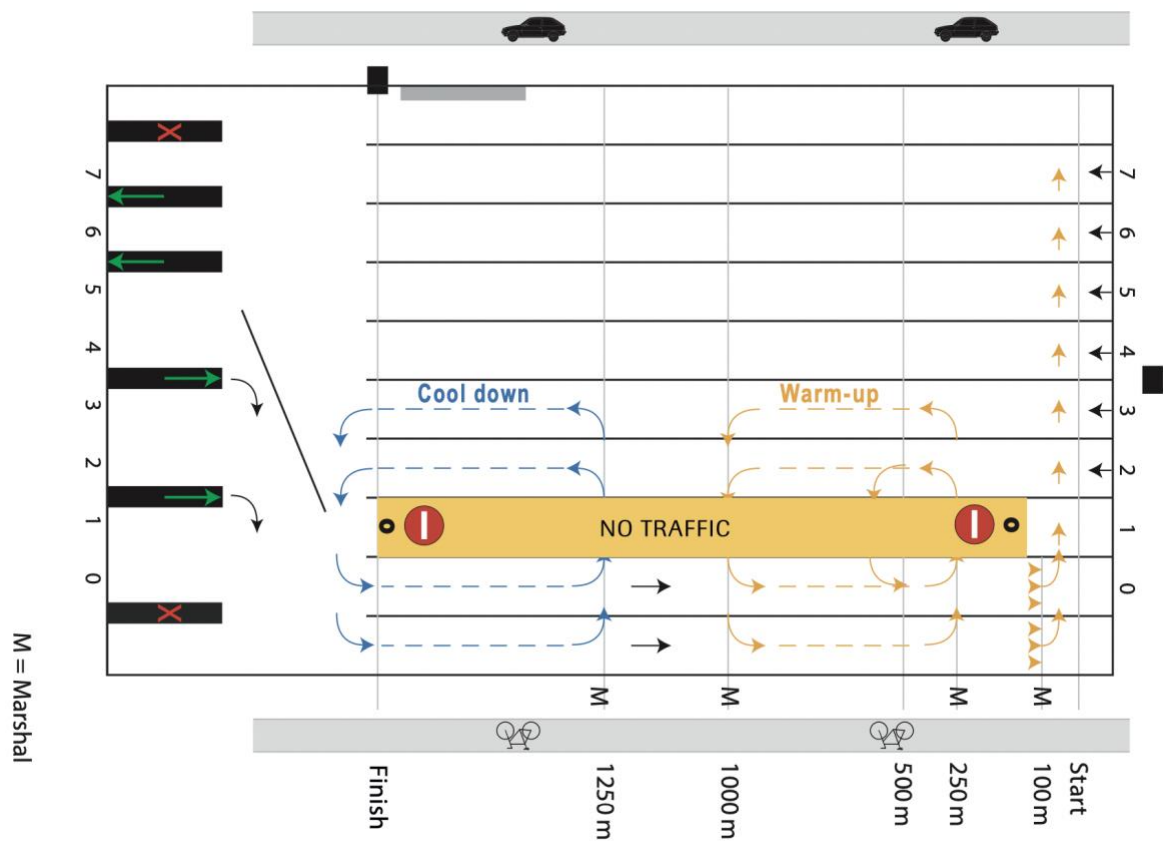

## Finals

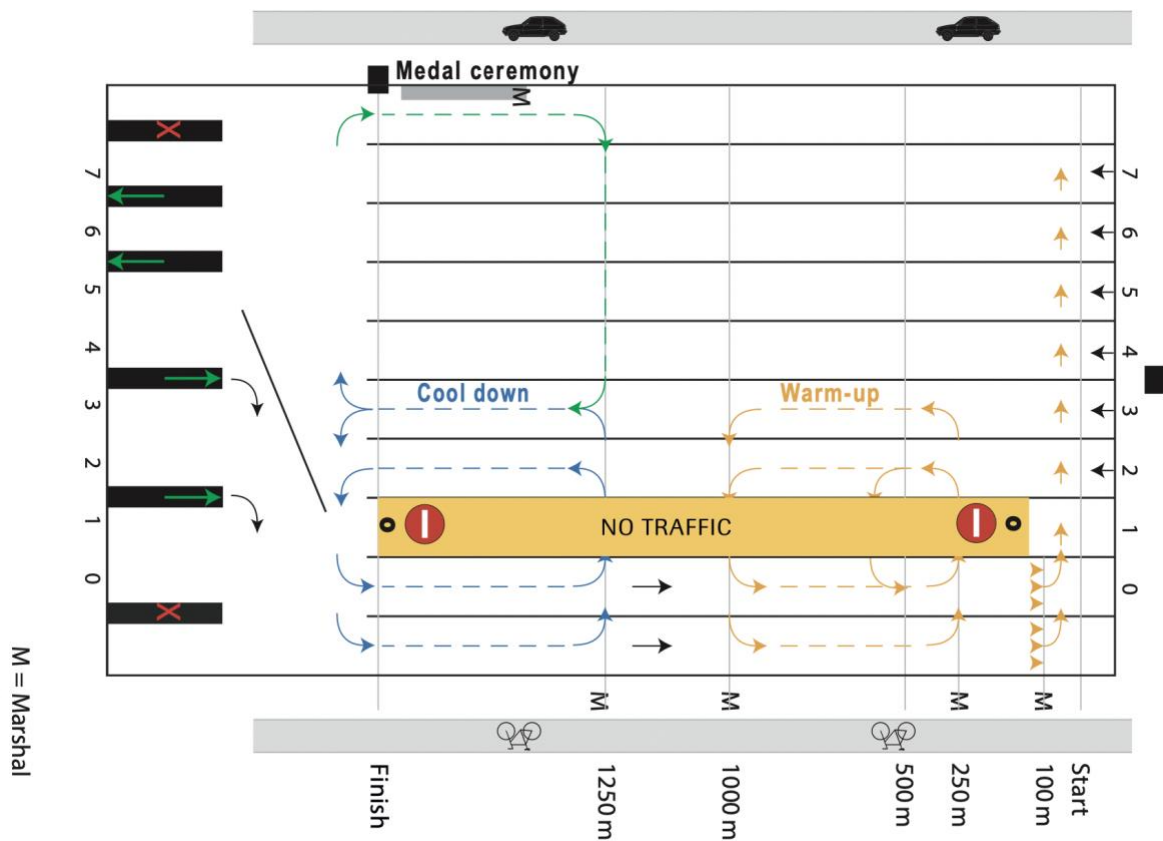



## Control Commission

The Control commission is located next to the outgoing pontoons (Venue Map No. 13) and will be in operation during all times the course is officially open.

## Crew Changes & Registration

Crew changes (including withdrawals) before Wednesday 6 October must be submitted via the official crew change form, which should be sent electronically by the team managers to [registration@worldrowing.com](mailto:registration@worldrowing.com). From Thursday 7 October onwards, the Crew Change forms should be submitted in hard copy to the European Rowing office at the venue. In case of a medical substitution or withdrawal, Team Managers must contact the OC doctor first by phone and then submit the crew change form at the venue.

All Team Managers are requested to check and confirm their entries by 14:00 on Friday 8 October (3 hours before the draw).

## Bow Numbers

The bow numbers will be distributed to the crews on the outgoing pontoon and collected at the incoming pontoon.

## Athletes Weighing

The Athletes Weighing is in the Team Information building (Venue Map No. 12). Weighing for coxes is possible 2 hours before until 1 hour before the respective race.

### Test Weighing

Thursday, 7 October	14:00 – 17:00
Friday, 8 October	12:00 – 13:00
	14:00 – 16:00

## Boat Weighing

The boat weighing is in boat hall 23 and is open as following

Thursday, 7 October	14:00 – 17:00
Friday, 8 October	12:00 – 13:00
	14:00 – 16:30

## Weather updates/adverse weather scenarios

### Weather Information per hour

Hour of the day	Wind velocity (m/s)	Wind direction	Temperature (°C)	Humidity (%)
06:00-07:00	2.3	WSW	8.7	93.7
07:00-08:00	2.3	WSW	8.6	93.5
08:00-09:00	2.4	WSW	8.9	93.7
09:00-10:00	2.9	WSW	9.4	91.5
10:00-11:00	3.3	WSW	10.2	88.2
11:00-12:00	3.4	SW	11.2	84.6
12:00-13:00	3.5	WSW	11.7	80.5
13:00-14:00	3.5	SW	12.3	77.6
14:00-15:00	3.6	WSW	12.7	74.7
15:00-16:00	3.7	SSW	13.3	72.7
16:00-17:00	3.5	WNW	13.3	72.9
17:00-18:00	3.3	WSW	13.1	74.3

18:00-19:00	2.4	WNW	12.6	77.5
19:00-20:00	2.2	WSW	11.5	83.7

#### Average Wind Speed

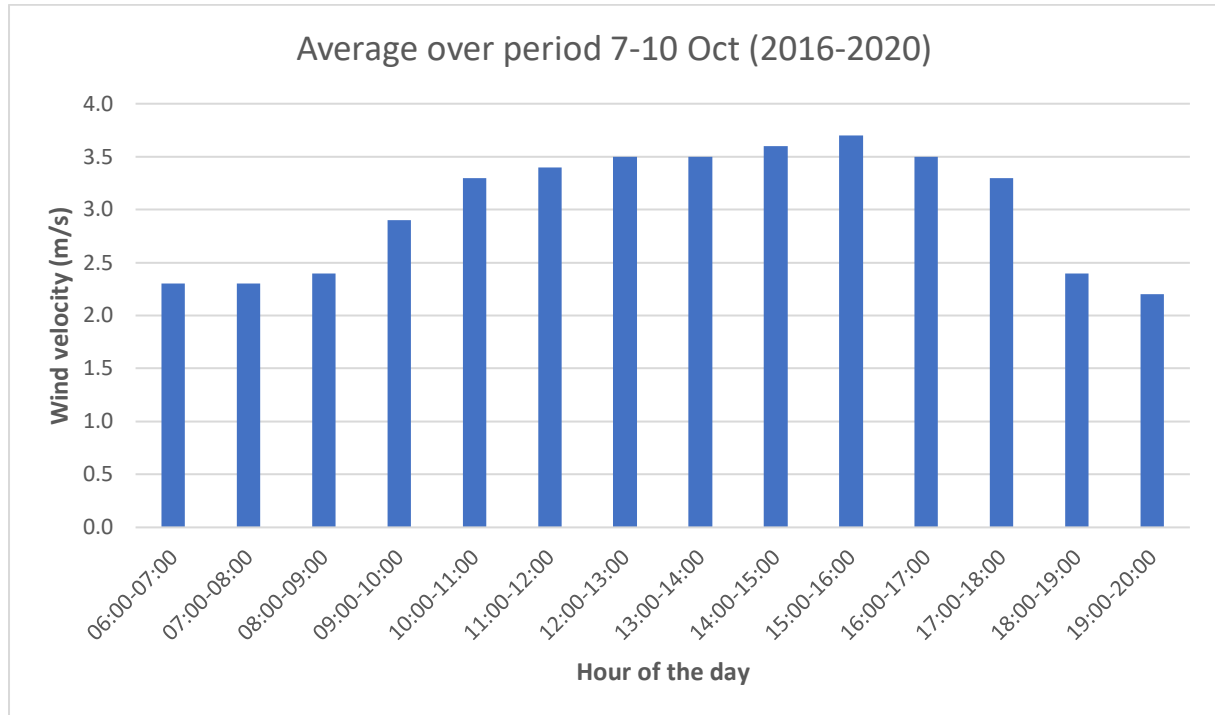

#### Average Temperature

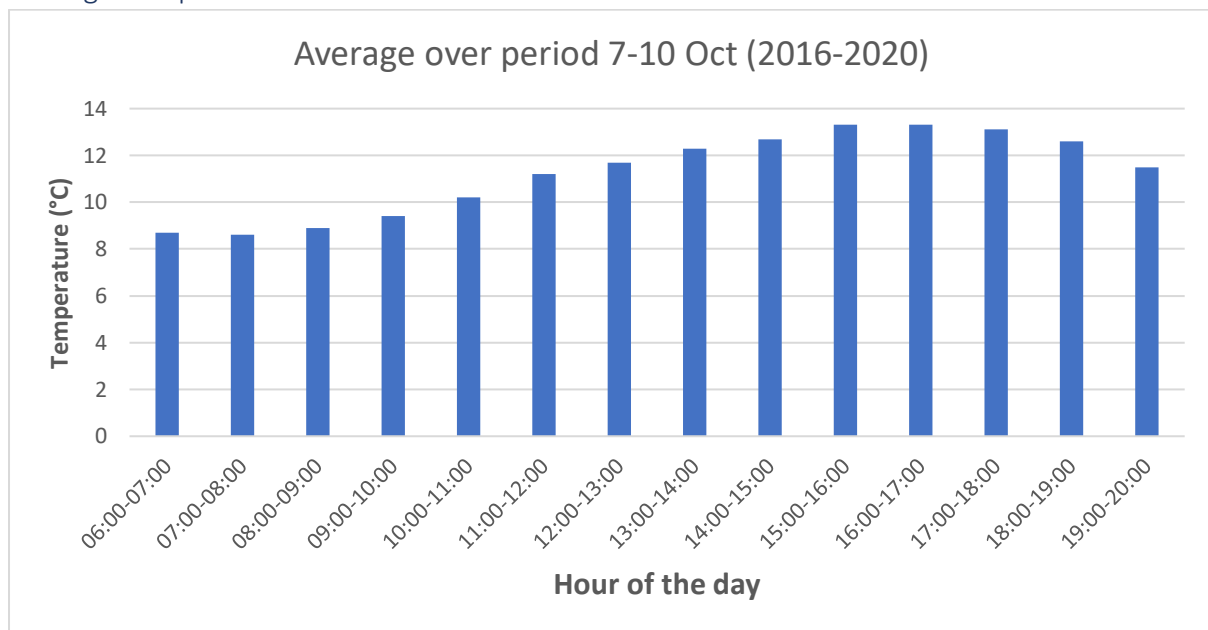

## Average Humidity

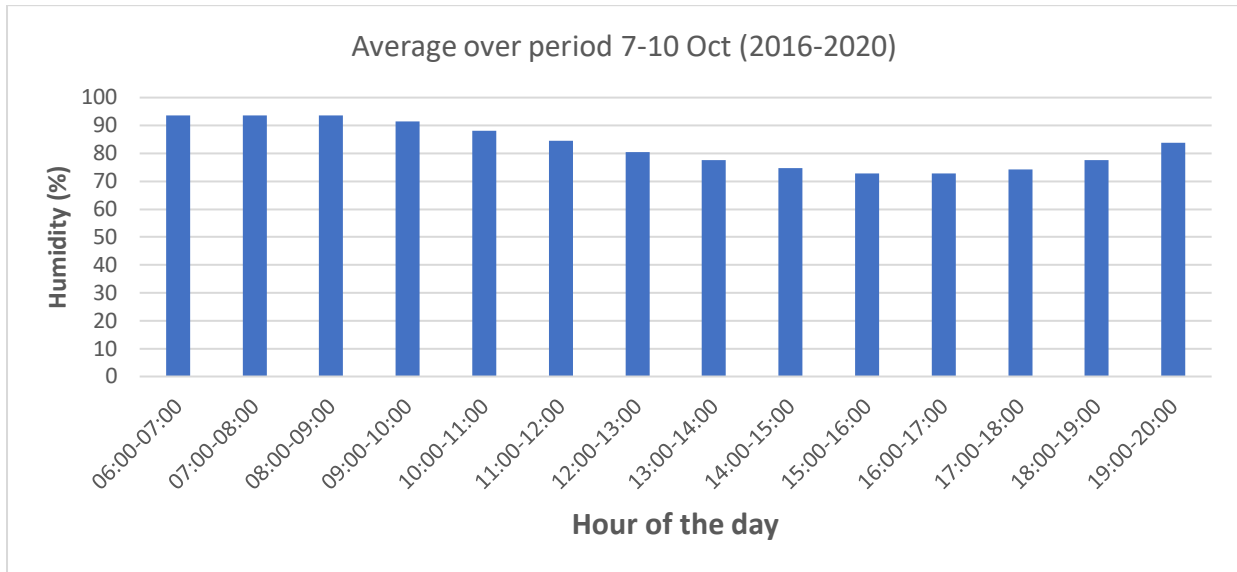

## Average Temperature and Humidity

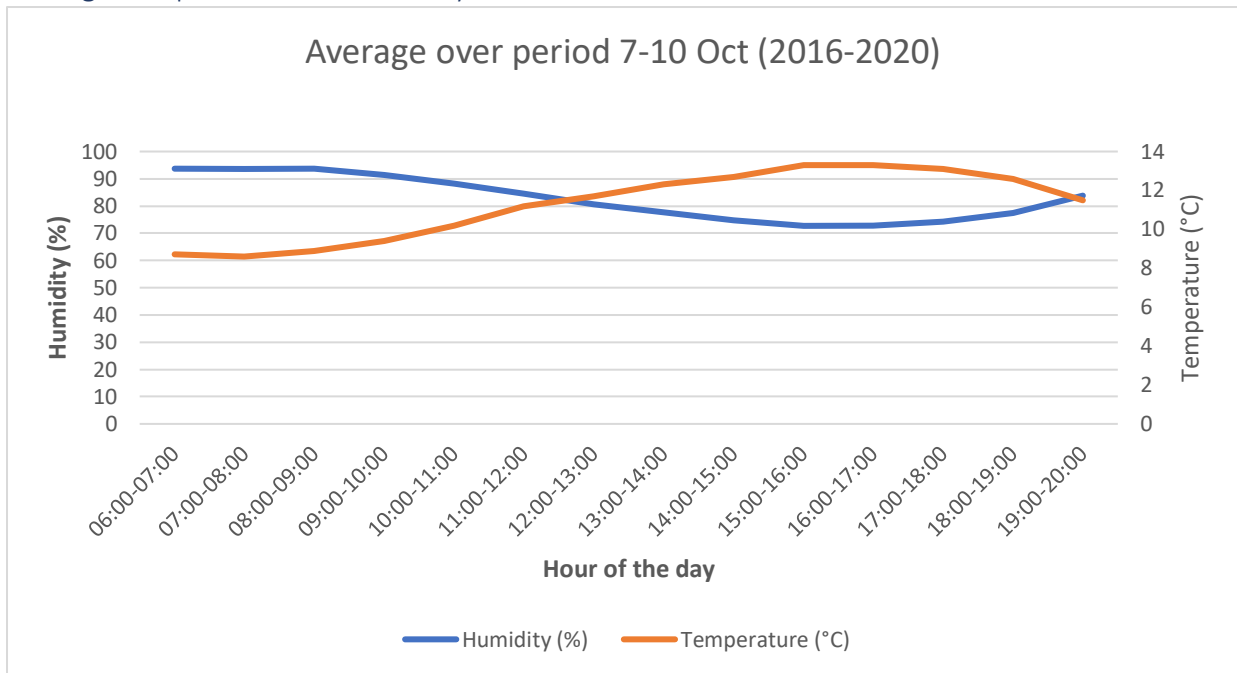

## Sunrise, Sunset & Daylight Information

Date	Sunrise	Sunset	Length of day (h)
Thursday, 07 October	07:22	18:39	11:16
Friday, 08 October	07:24	18:37	11:13
Saturday, 09 October	07:25	18:35	11:09
Sunday, 10 October	07:27	18:33	11:06

## Team Facilities and Services

### Venue Map

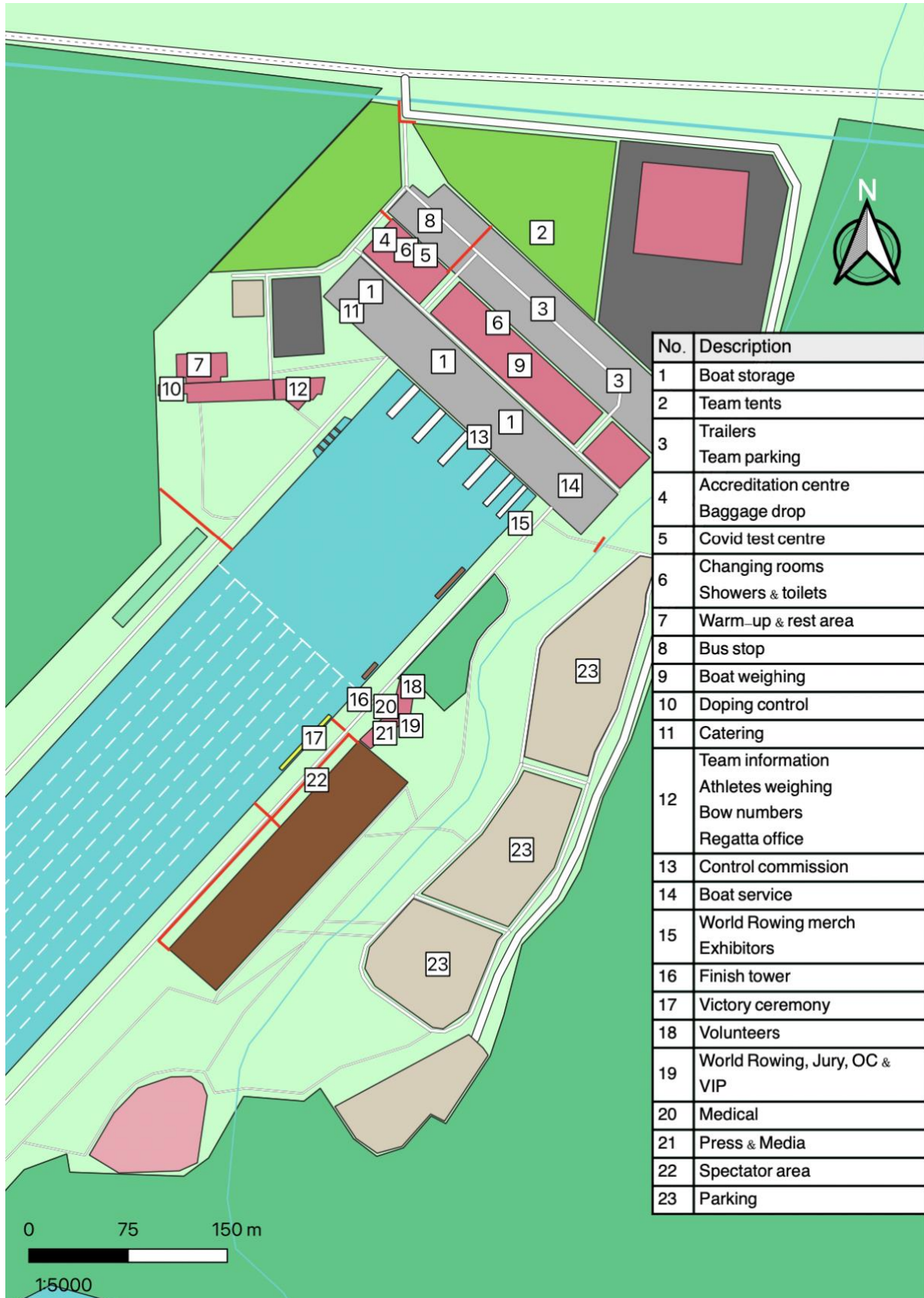

### Boat Storage

The Organising Committee will provide boat racks in the boat storage area and in selected boat hangars. The racks will be labelled according to boat category (1x, 2x/2-, 4x/4-, 4+, 8+), but will not be assigned to a specific crew. The Organising Committee will not be held responsible for any damage or losses. Teams are responsible for ensuring that boats are securely tied down at all times.

### Launch Pontoons

Teams must use the outgoing and incoming pontoons as shown on the traffic rules maps (see above). Shoes and items of clothing should not be left on the pontoons during training or racing sessions. Please do not leave plastic bottles or rubbish on the pontoons after training or racing.

### Team Tents

The area available for team tents is located behind the boat hangars and the boat trailer space (Venue Map No. 2). Team tents may only be set-up in the designated area.

### Changing Rooms, Showers and Toilets

There are changing rooms, showers and toilets located in two buildings in the boat park (Venue Map No. 6). The facilities will be cleaned frequently.

### Coaches Viewing

During training, coaches can follow on bikes from the path along the course on both sides of the course. During racing, coaches can follow the racing on the side opposite of the Finish Tower only. Teams will have free access to the terrace below the nation flags on the side opposite the Finish Tower.

### Baggage Drop

The baggage drop is in boat hangar 1 (Venue Map No.4) and will be open during all venue opening hours open. The OC does not take responsibility for items lost at the venue.

### Lost and Found

Lost and Found is located at the Team Information (Venue Map No. 12).

### Garbage Collection

Bins have been placed on the venue and in the boathouse area for garbage collection. All attendees are encouraged to use the recycling bins throughout the venue. For larger items, please use the containers close to the team tent area, the boat services park, or the team catering.

### Transportation and Parking Services for Teams

Transportation to and from the airport will be provided to the hotels or the venue for those teams that have booked the airport transfer service. Teams should confirm in advance if they wish to go from the airport directly to the venue, and whether they will bring oars.

A shuttle service between the venue and the official event hotels will be offered to all teams who booked the accommodation via the Organising Committee. The operating times will be published at the Team Information and on the event website [www.erjch2021.com](http://www.erjch2021.com).

Team cars and boat trailers can be parked at the trailer and team parking area (Venue Map No. 3).

## Food Facilities and Services

### Lunch at the Venue

Lunch will be served at the venue daily from 11:00 – 15:00. For teams who have booked accommodation via the Organising Committee, lunch is included in the full board rate. All other teams need to book lunch service in advance via <https://max.m-start.de>.

### Mealtimes at the Hotels

The mealtimes for breakfast and dinner at the event hotels vary by location. If you have specific requests, please contact [accommodation@regatta.de](mailto:accommodation@regatta.de).

## Medical Facilities and Services

### Medical Centre

The Medical Centre is in main regatta building (Venue Map No. 20) and is open during the venue opening hours.

### Doping Control

The Doping control (Venue Map No. 10) is in the Team Information building (Venue Map No. 12). For all information on the Doping control procedures, please refer to the World Rowing Rule Book. The latest WADA list of prohibited substances can be found on [www.wada-ama.org](http://www.wada-ama.org).

### First Aid Service, Ambulance and Local Hospital

An ambulance is located next to the Medical Centre during the venue opening hours. During racing, a medical car will be located near the incoming pontoons.

The closest hospital is the Helios Amper-Klinikum Dachau, Krankenhausstr. 15, 85221 Dachau, phone +49-(0)8131-76-0, located 10 minutes from the venue.

Medical emergencies: 112

### Important Note

The expenses for any medical treatments during your stay in Germany are the responsibility of the patient. All Member Federations are responsible for adequately insuring their team members according to Rule 15 of the World Rowing Rules of Racing.

## Covid-related rules and practices

### Covid Pre-Health screening

All participants (athletes, officials, support staff) attending the event will need to fill in a pre-event health questionnaire online. Please register in our online system <https://www.m-start.de> as a team manager (if you don't have a login yet from previous regattas in Munich). We will assign your athletes in the system automatically and you can fill in the questionnaires online or send them to your participants separately via email.

### Covid Test Centre Opening Hours

Daily rapid (antigen) testing will be offered on site in boat hangar 7 (shuttle stop side, Venue Map No. 5). The opening hours are:

Thursday, 7 October	15:30 – 17:30
Friday, 8 October	15:30 – 17:30
Saturday, 9 October	11:00 – 13:00 (PCR tests only) 16:00 – 18:00 (antigen tests only)
Sunday, 10 October	13:00 – 16:00

Tests must be booked online in advance via <https://max.m-start.de> and paid in advance.

Please see the Covid Response Plan for all further details on this topic.

### Spectators

The use of the existing grandstand at the venue is currently not permitted. The Organising Committee has found a solution to provide family and friends of the athlete's access to a viewing area in front of the old grandstand facing the medal ceremony.

Tickets can be purchased online at a price of 10 € per day. Please check our website at [www.regatta.de](http://www.regatta.de) for up-to-date information on the ticketing process.

Access to the area will be via the Munich Beach Resort. Parking for spectators will be 5 €/day.

Food services will be available at the Munich Beach Resort.

Please note: Germany's so called "3G-rule" (geimpft, genesen, getestet – vaccinated, recovered, tested) applies for any ticket purchase and will be checked upon entry.

As per the COVID Response Plan, Teams are required NOT to enter the spectator area, and should limit contact with spectators (keeping team and crew bubbles where possible). Team viewing is possible on the terrace under the nations flags on the side of the course opposite the finish tower.

### Media

#### Media Accreditation

Media Accreditations for the 2021 European Rowing Junior Championships are managed by World Rowing. Please fill in the online form for the [media accreditation](#). Please note, media accreditation will close 10 days before the start of the event.

#### Media Centre

A limited number of working stations will be made available at the Media Centre (Venue Map No. 21) close to the Finish Tower.

## Partners



## Sponsors

Gefördert durch:



Bundesministerium  
des Innern, für Bau  
und Heimat



City of Munich

aufgrund eines Beschlusses  
des Deutschen Bundestages

